



*Protecting you for life's best moments.®*

C40™ CLIMATE CONTROL DEVICE UI R8

GVS-RPB.COM

# Instruction Manual

## C40™ Climate Control Device

**Employers:** Read this manual and the respirator headtop instruction manual and carry out the employer responsibilities (page 7).

**Product users:** Read this manual and the respirator headtop instruction manual and follow the product user safety instructions (page 9).

Manuals are regularly updated. Make sure this manual is available to all users for reference.

**Current version of manual and other languages:** [gvs-rpb.com/industrial/resources](https://gvs-rpb.com/industrial/resources)



**NIOSH**  
APPROVED

## CONTENTS

■ EXPLANATION OF SIGNAL WORDS AND SYMBOLS	2
■ INTRODUCTION	3
■ IMPORTANT SAFETY INFORMATION	
□ PROTECTION PROVIDED AND LIMITATIONS	4
□ RESPIRATORY COMPONENT DIAGRAM - NIOSH CAUTIONS & LIMITATIONS	5
□ AIR SOURCE, FITTINGS, AND PRESSURE	6
□ EMPLOYER RESPONSIBILITIES	7
□ PRODUCT USER SAFETY INSTRUCTIONS	9
■ SETUP AND CARE	11
■ FLOW AND TEMPERATURE CHART	16
■ PARTS AND ACCESSORIES	18
■ WARRANTY AND LIABILITY STATEMENT	20

## EXPLANATION OF SIGNAL WORDS AND SYMBOLS

The following signal word and safety symbols are used in this manual and product labeling:



**WARNING**

**WARNING** indicates a hazardous situation that, if not avoided, could result in death or serious injury.



**DANGER**

**DANGER** Indicates a hazardous situation that, if not avoided, will result in death or serious injury.



**Read the Instruction Manual.**

Additional copies of RPB® manuals can be found at [gvs-rpb.com](http://gvs-rpb.com).

**RPB® Safety LLC is an ISO9001 certified company.**

## INTRODUCTION

The RPB® C40™ Climate Control Device is designed for use in many different industries such as blasting, painting, grinding and other such areas where you would like to adjust the air temperature in the respirator hood.

This product must be inspected and maintained in accordance with this instruction manual at all times.

See PROTECTION PROVIDED AND LIMITATIONS (page 4) for details.

### **RPB® SAFETY - GLOBAL HEADQUARTERS**

2807 Samoset Rd, Royal Oak, MI 48073, USA.

T: 1-866-494-4599 F: 1-866-494-4509 E: sales.us@gvs.com

### **RPB® SAFETY - APAC**

3 Robin Mann Place, Christchurch Airport, Christchurch 8053, New Zealand

T: +64-3-357-1761 F: +64-3-357-1763 E: sales@gvs.com

### **GVS S.p.A. - EMEA**

Via Roma 50, 40069 Zona Industriale BO, Italy

T: +39 0516176391 E: sales@gvs.com

[gvs-rpb.com](http://gvs-rpb.com)

Copyright ©2022 RPB IP, LLC. All rights reserved. All materials contained on this website are protected by United States copyright law and may not be reproduced, distributed, transmitted, displayed, published or broadcast without the prior written permission of RPB IP, LLC. You may not alter or remove any trademark, copyright or other notice from copies of the content.

All trademarks, service marks, and logos used in this publication, both registered and unregistered, are the trademarks, service marks, or logos of their respective owners. The green and gray color combination is a registered trademark of RPB IP, LLC. All rights in the RPB Intellectual Property contained in this publication, including copyright, trademarks, service marks, trade secret, and patent rights are reserved. RPB Intellectual Property means any patent, patented articles, patent applications, designs, industrial designs, copyrights, software, source code, database rights, moral rights, inventions, techniques, technical data, trade secrets, know-how, brands, trademarks, trade names, slogans, logos, and any other common law and proprietary rights, whether registered or unregistered anywhere in the world, that are owned by, developed in whole or in part by, or licensed by RPB IP, LLC.

For technical assistance contact our Customer Service Department at 1-866-494-4599 or email: [sales@gvs.com](mailto:sales@gvs.com)

Form #: 7.20.522

Rev: 8

## IMPORTANT SAFETY INFORMATION

### **WARNING**

Improper selection, use, or maintenance of this product can result in injury; life threatening delayed lung, skin or eye disease; or death.

This product is intended for occupational use in accordance with applicable standards or regulations for your location, industry, and activity (see Employer Responsibilities, page 7). Familiarity with standards and regulations related to the use of this protective equipment is recommended, even if they do not directly apply to you. If self-employed or if used in a non-occupational setting, refer to Employer Responsibilities and Product User Safety Instructions. Go to [gvs-rpb.com/important-safety-information](https://gvs-rpb.com/important-safety-information) for helpful links to OSHA and other content.

**EMPLOYERS:** Read this manual and the head-top Instruction Manual and carry out the Employer Responsibilities (page 7).

**PRODUCT USERS:** Read this manual and the head-top Instruction Manual and follow the Product User Safety Instructions (page 9).

**CHECK WEBSITE FOR UPDATES.** Product manuals are regularly updated.

Visit [gvs-rpb.com/industrial/resources](https://gvs-rpb.com/industrial/resources) for the most recent version of this manual before using the product.

## PROTECTION PROVIDED AND LIMITATIONS

### RESPIRATION

The RPB® C40™ is part of an approved respirator by NIOSH as a flow control device in the categories as follows:

#### Supplied Air

The RPB® C40™ Climate Control Device, when properly fitted and used with all required components, including the head top, breathing tube assembly, and breathing air line is part of a NIOSH approved respirator. Refer to the head top approval label to verify that it is approved for use with the C40™. Refer to the instruction manual for the head top being used for the Assigned Protection Factor. As such, it significantly reduces, but does not completely eliminate, the breathing of contaminants by the respirator wearer. Use with an airline filter, such as the 04-900 RPB® RADEX® Airline Filter. Specific protection depends on the setup of the airline filter (see the Instruction Manual for RPB® RADEX® or for which ever airline filter is used).

### HAZARD LIMITATIONS

The RPB® C40™ Climate Control Device is **NOT FOR USE** if:

- In atmospheres immediately dangerous to life or health (IDLH).
- Wearer cannot escape without the aid of the respirator.
- Atmosphere contains less than 19.5% oxygen.
- For protection against hazardous gases (e.g., carbon monoxide).
- Contaminants are in excess of regulations or recommendations.
- Contaminants or contaminant concentrations are unknown.
- Work area is poorly ventilated.
- The temperature is outside the range of 14°F to 140°F (-10°C to +60°C).

**INSERT APPROVAL LABEL HERE**

## RESPIRATOR COMPONENT DIAGRAM

An RPB® Respirator consists of 3 main components:

### 1. RESPIRATOR

#### HELMET

#### ASSEMBLY □

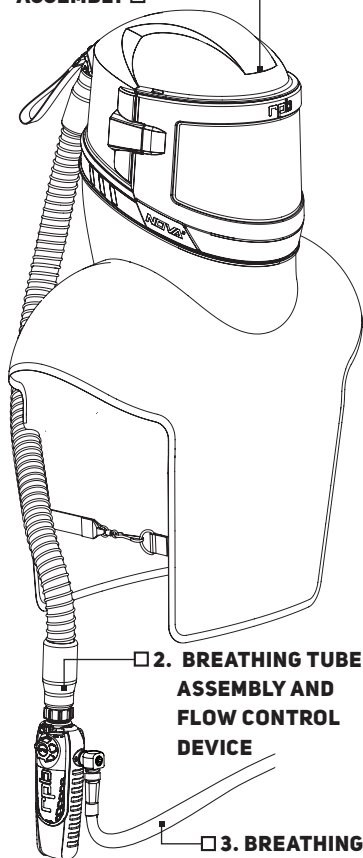

FIGURE 1.1

## NIOSH - CAUTIONS AND LIMITATIONS

- A. Not for use in atmospheres containing less than 19.5 percent oxygen.
- B. Not for use in atmospheres immediately dangerous to life or health.
- C. Do not exceed maximum use concentrations established by regulatory standards.
- D. Air-line respirators can be used only when the respirators are supplied with respirable air meeting the requirements of CGA G-7.1 Grade D or higher quality.
- E. Use only the pressure ranges and hose lengths specified in the user's instructions.
- J. Failure to properly use and maintain this product could result in injury or death.
- M. All approved respirators shall be selected, fitted, used and maintained in accordance with MSHA, OSHA, and other applicable regulations.
- N. Never substitute, modify, add or omit parts. Use only exact replacement parts in the configuration as specified by the manufacturer.
- O. Refer to user's instructions, and/or maintenance manuals for information on use and maintenance of these respirators.
- S. Special or Critical User Instructions and/or specific limitations apply. See Special or Critical Instructions on page 13.

## AIR SOURCE, FITTINGS, AND PRESSURE

### AIR SOURCE

#### Supplied Air

Locate the air source in a clean air environment, always use a filter on the inlet of your air source. Make sure the air source is somewhere that vehicles, forklifts, and other machinery are not running near the air inlet, as this will cause carbon monoxide to be drawn into your air supply. Always use suitable after coolers/dryers with filters and carbon monoxide alarms to ensure clean breathable air is supplied at all times. A Radex® Airline Filter (04-900) and a GX4® Gas Monitor (08-400) are recommended. The air should be regularly sampled to ensure that it meets Grade D requirements.

### AIR QUALITY

This respirator must be supplied with clean breathable air at all times. Breathable air must at least meet the requirements for Type 1 gaseous air described in the Compressed Gas Association Commodity Specifications G-7.1 (Grade D or higher) and as specified by the regulation 42 CFR 84, subpart J.84.141(b) and 29 CFR 1910.134 (i) the RPB® C40™ does not purify air or filter contaminants. A carbon monoxide monitor must be used at all times.

#### **DANGER**

Do not connect the respirator's air supply hose to nitrogen, toxic gases, inert gases or other unbreathable non-Grade D air sources. Check the air source before using the respirator. This apparatus is not designed for use with mobile air supply systems i.e. cylinders. Connecting the supply hose to a non-breathable air source will result in serious injury or death.

### BREATHING AIR SUPPLY HOSES AND FITTINGS

RPB® air supply hoses and fittings must be used between the point of attachment and the respirator breathing air connection at the wearer's belt. The hose sections must be within the correct length and the amount of sections must be within the number specified in the breathing air pressure table in the head-top instruction manual.

### BREATHING AIR PRESSURE

The air pressure must be continually monitored at the point of attachment. Air pressure must be read from a reliable pressure gauge whilst the respirator has air flowing through it.

## EMPLOYER RESPONSIBILITIES

Your specific responsibilities may vary by location and industry, but in general RPB® expects that employers will:

### ■ Follow all applicable standards and regulations for your location, industry, and activity.

Depending on your location and industry, a number of standards and regulations may apply to your selection and use of respirators and other personal protective equipment. These may include such things as federal (e.g., OSHA, MSHA, Canadian Occupational Health and Safety), local (e.g., state, provincial), or military standards and regulations and consensus standards such as ANSI and CSA. There are also requirements specific to particular contaminants, e.g. silica (see [gvs-rpb.com/important-safety-information/](https://gvs-rpb.com/important-safety-information/) for more information), asbestos, organic pathogens, etc. Know which requirements apply to your location and industry.

### ■ Have appropriate safety programs in place.

Have and follow:

- ☐ A workplace safety program.
- ☐ A written respiratory protection program in accordance with applicable standards and regulations (e.g., OSHA 29 CFR 1910.134; ANSI/ASSE Z88.2; CSA Z94.4, etc.).

### ■ In accordance with the above,

- ☐ **Perform a hazard analysis and select appropriate equipment for each activity.** A hazard analysis should be performed by a qualified person. Controls should be in place as appropriate and a qualified person should determine what kind of respiratory, face and eye, head, and hearing protection is appropriate for the intended activities and environments of use. (For example, select a respirator appropriate to the specific airborne hazards, with consideration of workplace and user factors and with an Assigned Protection Factor (APF) that meets or exceeds the required level for employee protection, select welding face and eye protection appropriate to the type of welding to be done, etc.)

As applicable, check your workplace safety program, respiratory protection program, and standards and regulations for your activity or industry for related protection requirements, and see this manual (Protection Provided and Limitations, page 4) and the head-top Instruction Manual for product specifications.

- ☐ **Be sure employees are medically qualified to use a respirator.**

Have a qualified physician or other licensed health care professional (PLHCP) perform medical evaluations using a medical questionnaire or an initial medical examination per OSHA 29 CFR 1910.134.

- ☐ **Train employees in the C40™'s use, maintenance, and limitations.**

Appoint a qualified individual who is knowledgeable about the RPB® C40™ per ANSI/ASSE Z88.2 standard to provide training:

Section 8.1 Qualifications of the Respirator Trainer. Anyone providing respirator training shall:

- a) be knowledgeable in the application and use of the respirator(s);
- b) have practical knowledge in the selection and use of respirator(s) and work practices at the site;

## EMPLOYER RESPONSIBILITIES CONTINUED

- c) have an understanding of the site's respirator program; and
- d) be knowledgeable of applicable regulations.

Train each C40™ user in the product's use, application, inspection, maintenance, storage, fitting, and limitations in accordance with the content of this Instruction Manual and the approved head-top Instruction Manual and standard or regulatory requirements. Ensure that each intended user reads both these manuals.

☐ **Ensure that equipment is properly set up, used, and maintained.**

Make sure that equipment is properly set up, inspected, fitted, used, and maintained, including wearing the C40™ on the belt secure around the user's waist, the U-Tube is clean, and the silencers are in place.

☐ **Measure and monitor airborne contaminants in the work area.**

Measure and monitor airborne contaminant levels in the work area in accordance with applicable requirements. Make sure work area is well ventilated.

☐ **If you have any questions, contact RPB®.**

■ Call Customer Service Department at:

Tel: 1-866-494-4599

Email: [sales@gvs.com](mailto:sales@gvs.com)

Web: [gvs-rpb.com](http://gvs-rpb.com)



# PRODUCT USER SAFETY INSTRUCTIONS

## BEFORE INITIAL USE - BE TRAINED AND MEDICALLY QUALIFIED

Do not use this device until you have read this manual and the head-top Instruction Manual (additional copies available at [gvs-rpb.com/resources](http://gvs-rpb.com/resources)) and been trained in the respirator's use, maintenance, and limitations by a qualified individual (appointed by your employer) who is knowledgeable about the RPB® C40™ Climate Control Device.

Do not wear this respirator until you have passed a medical evaluation using a medical questionnaire or an initial medical examination by a qualified physician or other licensed health care professional (PLHCP).

**Allergens:** No known common allergens are used in this product.

Some materials could cause an allergic reaction in susceptible individuals. If you have a known allergy or develop irritation, inform your employer. Irritation may occur from lack of cleaning. Following all cleaning and care instructions provided in the instruction manuals for this and any other RPB® products you are using.

## MAKE SURE THE SYSTEM IS READY FOR USE

**Make sure you have a complete system.** The C40™ is only one component of a NIOSH approved respirator system. Verify that you have all required components to serve as a complete NIOSH approved respirator:

- Respirator Head-Top Assembly
- Breathing Tube Assembly
- C40™ Climate Control Device
- Breathing Air Line

See *Respirator Component Diagram* (page 5). Check the head-top approval label to verify it is approved to be used with the RPB® C40™. Use only authentic RPB® brand parts and components that are part of the NIOSH approved respirator assembly. Using incomplete or inappropriate equipment, including the use of counterfeit or non-RPB® parts, can result in inadequate protection and will void the NIOSH approval of the entire respirator. Do not modify or alter any part of this product. The C40™ Climate Control Device cannot be used with a Low Pressure Air Pump as they do not supply a sufficient amount of air flow.

**Follow the Setup and Care instructions** to inspect all components daily, including the internal components, for signs of damage or wear and tear that may reduce the level of protection originally provided. Remove any damaged component or product. Damaged components should be replaced with genuine RPB® brand replacement parts. Inspect the inside of the C40™ for respirable dust or other foreign objects. Keep the inside of the C40™ clean at all times.

**Make sure that the C40™ is correctly assembled.** Never use the device without all components in place. An incomplete or improperly installed C40™ system could provide inadequate respiratory protection. See *Setup and Care* (page 11).

## PRODUCT USER SAFETY INSTRUCTIONS CONTINUED

### BEFORE DONNING THE RESPIRATOR WITH THE C40™:

#### Verify airborne contaminants are within recommended limits for respirator use:

- Determine the type and level of contamination. Verify that airborne contaminant concentrations do not exceed those allowed by applicable OSHA, EPA, or NIOSH regulations and recommendations for supplied air respirators.

#### Make sure the area is ventilated and monitored:

- Make sure that the area is well ventilated and that regular air samples are taken to confirm the atmosphere stays within the levels recommended by OSHA and other governing bodies. For Supplied Air, it is recommended to use a GX4® Gas Monitor. Follow the GX4® Gas Monitor Instruction Manual.

If you have any questions, ask your employer.

#### DO NOT ENTER THE WORK AREA if any of the following conditions exist:

- Atmosphere is immediately dangerous to life or health.
- You cannot escape without the aid of the respirator.
- Atmosphere contains less than 19.5% oxygen.
- Contaminants are in excess of regulations or recommendations.
- Contaminants or contaminant concentrations are unknown.
- Work area is poorly ventilated.
- The temperature is outside the range of 14°F to 140°F (-10°C to +60°C).

#### LEAVE THE WORK AREA IMMEDIATELY IF:

- Any product component becomes damaged.
- Vision is impaired.
- Airflow stops or slows down.
- Breathing becomes difficult
- You become dizzy, nauseous, too hot, too cold, or ill.
- Your eyes, nose, or skin become irritated.
- You taste, smell, or see contaminants inside the helmet.
- You have any other reason to suspect that the respirator is not providing adequate protection.

### PRODUCT CARE

Never place the C40™ on hot surfaces. Do not apply paints, solvents, adhesives or self-adhesive labels except as instructed by RPB®. This product may be adversely affected by certain chemicals.

See the "Inspection, Cleaning and Storage" section (p. 13) for cleaning instructions.

## SETUP AND CARE

FIGURE 1.2

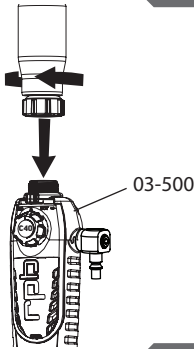

### ATTACH THE BREATHING TUBE

Thread on the loose running nut of the Breathing Tube on to the C40™ Climate Control Device (O3-500). Screw the running nut in a clockwise direction until tight.

FIGURE 1.3

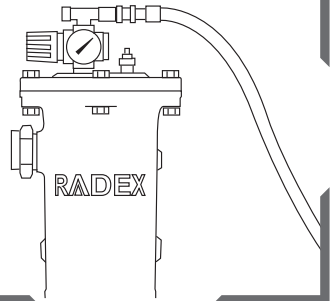

### CONNECT AIR SUPPLY HOSE

Connect a RPB® Breathing Air Line insuring the maximum sections and lengths are within the specifications of the Breathing Air Pressure Table in the head-top instruction manual.

FIGURE 1.4

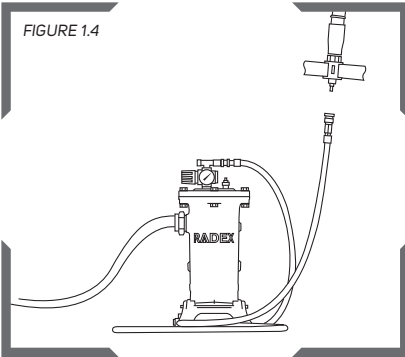

### ADJUST AIR PRESSURE

Adjust the air pressure at the point of attachment according to the Breathing Air Pressure Table in the head-top instruction manual. Then connect the Breathing Air Line to the flow control device.

FIGURE 1.5

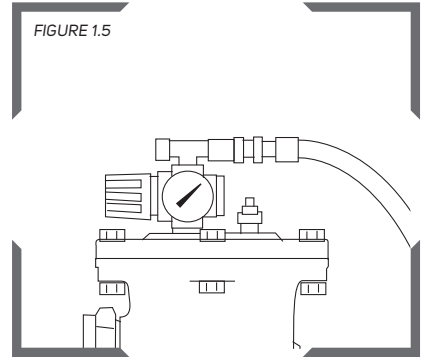

### CHECK AIR PRESSURE

Re-check the air pressure at the point of attachment and adjust it if necessary. Ensure you are comfortable with the flow of air inside the respirator.

## SETUP AND CARE CONTINUED

FIGURE 1.6

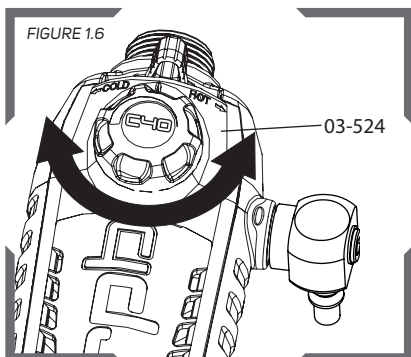

### ADJUSTING THE FLOW RATE

Air flowing into the respirator is controlled by the C40™ (03-500) by turning the Flow Knob (03-524). Note: With the pressure set according to the Breathing Air Pressure Table, the flow rate of air through the respirator should always exceed the minimum of 170 slpm.

FIGURE 1.7

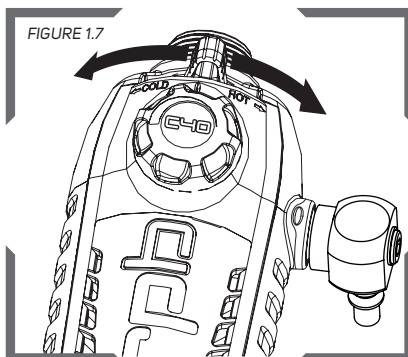

### ADJUSTING THE TEMPERATURE

To obtain cooler air, slide the regulator control selector to the left. This will increase the air flow out of the exhaust port. Similarly, slide the selector to the middle, this will increase the temperature of the air closer to the ambient temperature of your air supply, slide to the right for hot air.

### **⚠ WARNING**

Do not use the C40™ on the cold setting when ambient temperature is below 68° (20°C) as ice could form in the cold air outlet resulting in insufficient airflow. Do not ingest ice that is formed on the C40™ Climate Control Device. Ice may have contaminants in it that could be dangerous to your health.

### BREATHING AIR PRESSURE TABLE

#### **S - Special or Critical Users Instructions**

Refer to the head-top instruction manual for Breathing Air Pressure Table. This table lists air pressure ranges needed to provide the RPB® Supplied Air Respirators when using the C40™ Climate Control Device with the volume of air that falls within the required range of 6-15cfm or 170-425 slpm according to U.S government regulations.

## INSPECTION, CLEANING AND STORAGE

### C40™ Climate Control Device

The RPB® C40™ Climate Control Device has a limited service life, and therefore a regular inspection and replacement program must be conducted. All components of a Respirator Assembly including the Breathing Air Line, Head-top and Flow Control Devices should be inspected for damage and wear and tear, before use. Every 3 months it is recommended to disassemble the C40 to where the clear U-Tube is visible to inspect. If any damaged or worn parts are found, they should be replaced immediately, or the unit disposed of. Use only parts and components that are part of the NIOSH approved respirator assembly as set out in this instruction manual or that of the head-top. Refer to the parts list on page 19 for the correct part numbers to replace parts of the C40™ Climate Control Device. Clean with water and mild detergent or a disinfecting wipe. Dry all parts and reassemble.

Store the C40™ in a cool dry environment with the rest of the respirator assembly, or by itself in a sealed container or bag outside of the work environment.

### Breathing Air Line

Inspect the Breathing Air Line for cuts, cracks, blisters and excessive wear. Ensure the hose has not been crushed or kinked and that fittings are tightly crimped to the hose so air cannot escape. Replace the hose immediately if there are any signs of damage or wear.

Do not run water through the inside of the hose. Check Quick Disconnect Couplings and use compressed air to remove any particles that may jam the coupler.

## DISASSEMBLY INSTRUCTIONS

Let the device cool after use before disassembly. The inner components of this C40™ Climate Control Device will become very hot, take care when removing the parts so that you do not get burned. Allow sufficient time for the device to cool down before dismantling the device.

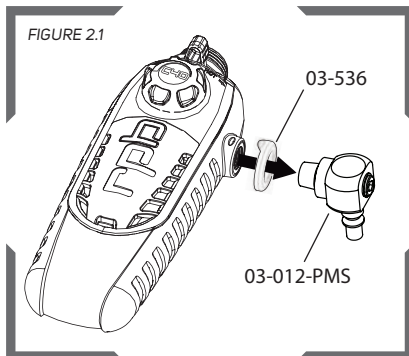

The first step is to use the Allen key to unscrew the Swivel Connector (03-012-PMS) from the body of the C40™. Unclip the (03-536) from the C40™ (03-500).

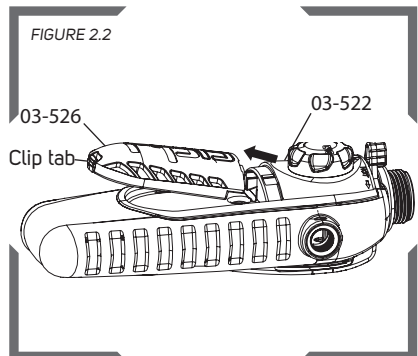

1. Push the clip tab on the Exhaust Cover (03-526) in until it unclips from Exhaust Case (03-522). 2. Lift up the (03-526) and slide it out of the (03-522).

## SETUP AND CARE CONTINUED

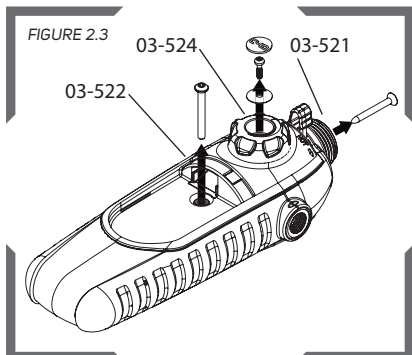

Remove the Cap from the Flow Knob (03-524) and then the screw and washer in the (03-524), as well as the screw from the Exhaust Case (03-522) and Top Casing (03-521) as shown in Figure 2.3.

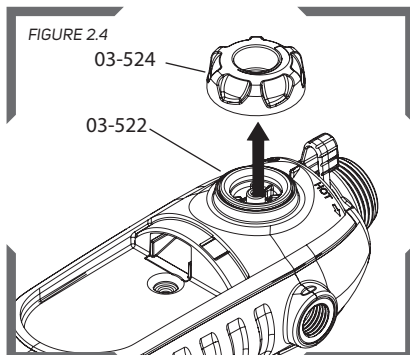

Remove the Flow Knob (03-524) from the Exhaust Case (03-522).

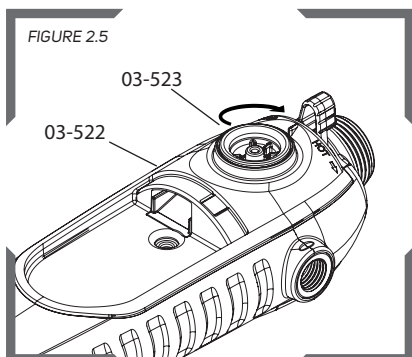

While pressing down firmly on Exhaust Case (03-522) turn the Flow Valve (03-523) 180° clockwise.

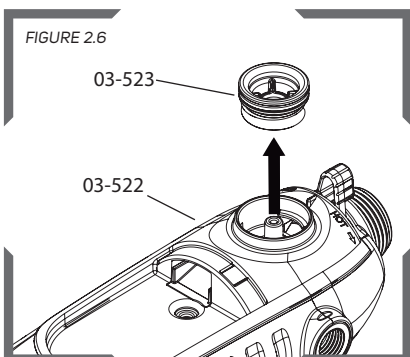

Remove the Flow Valve (03-523) from the Exhaust Case (03-522), taking care that the small center o-ring stays in place.

FIGURE 2.7

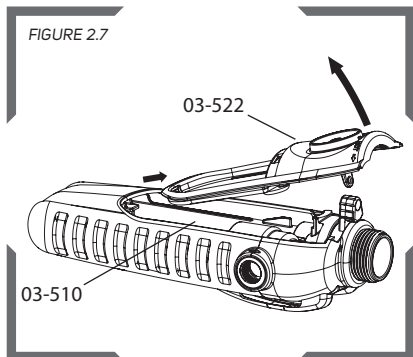

1. Lift the Exhaust Case (03-522) up from the U-Tube (03-510) 2. Slide the 03-522 out from the 03-510.

FIGURE 2.8

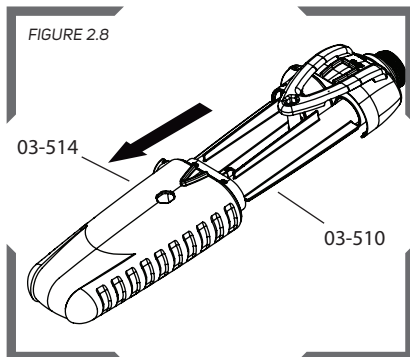

Lift the Belt Loop over the Bottom Case (03-514) to allow it to slide down off of the U Tube (03-510).

FIGURE 2.9

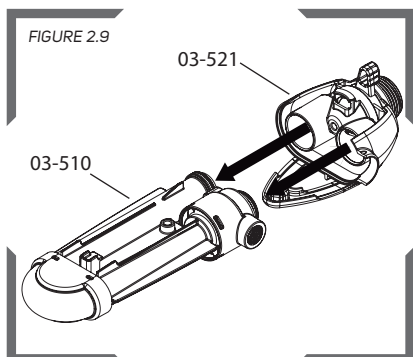

To finish disassembly of your C40™, take the U-Tube (03-510) and slide it off of Top Case (03-521).

**Note:**

To assist in reassembly, fit the belt before installing the screws as per Figure 2.3.

Silencer plates are included in part 03-526 (Exhaust Cover and Silencers). These must be fitted when the 03-500 is in use.

## SETUP AND CARE CONTINUED

FIGURE 3.1

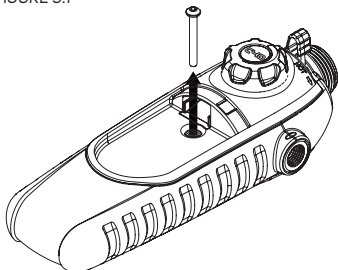

To change the belt loop, remove the center screw and slide the old belt loop off, over the threaded outlet.

FIGURE 3.2

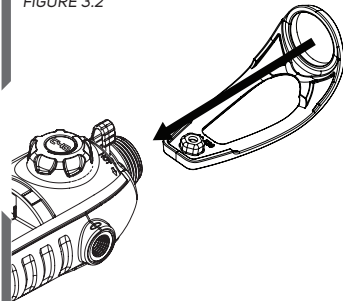

To install the new belt loop, slide it on over the threaded outlet and line up the hex nut indentation with the hole in the back of the housing. Reinsert the center screw and reassemble the silencers and exhaust cover.



# FLOW AND TEMPERATURE CHART

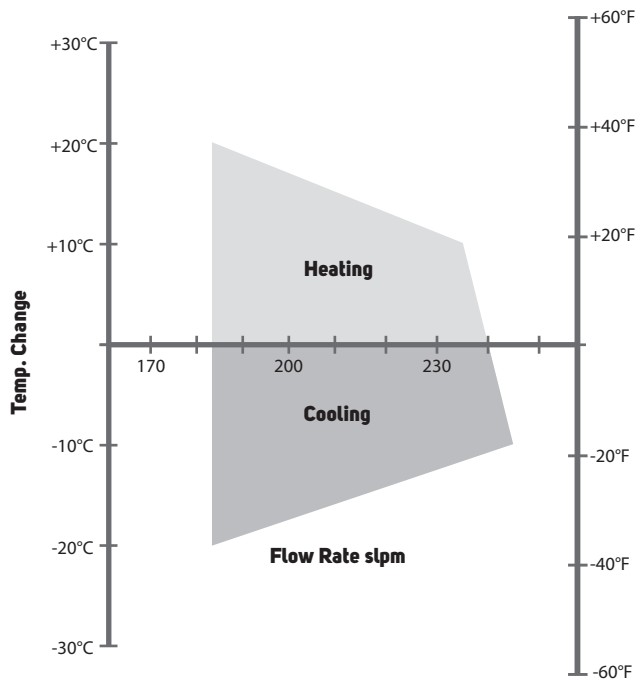
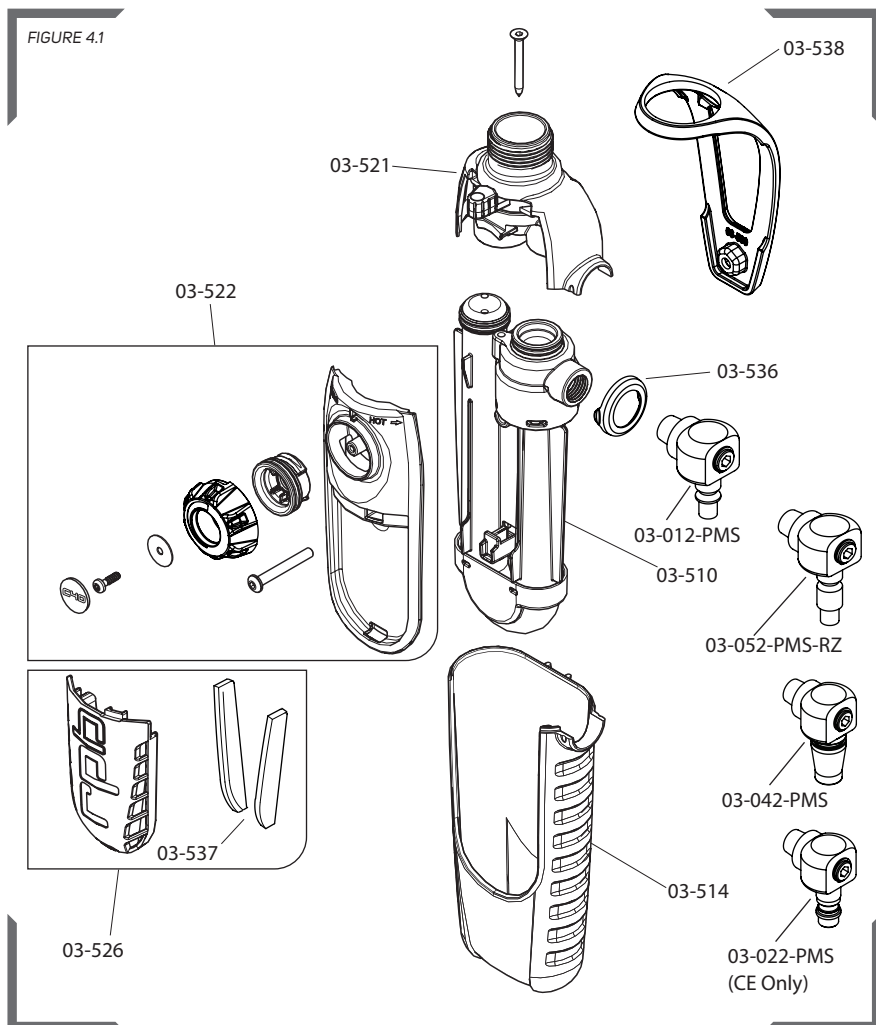

FIGURE 3.1

This chart shows the relationship between the flow rate and it's effect on the heating and cooling of the air. The lower the flow rate, the more heating and cooling is achieved. The flow rate must stay above 170 slpm at all times.

## PARTS AND ACCESSORIES

FIGURE 4.1



### WARNING

Use only exact, authentic RPB® replacement parts (marked with the RPB® logo and part number), and only in the specified configuration. Using incomplete or inappropriate equipment, including the use of counterfeit or non-RPB® parts, can result in inadequate protection and will void the NIOSH approval of the entire respirator assembly.

## PARTS LIST

Item No.	Description	Part Number
1	U-Tube Assembly	03-510
2	Bottom Case	03-514
3	Top Case Assembly	03-521
4	Exhaust Assembly	03-522
5	Silencer Assembly	03-526
6	Silencers	03-537
7	RPB Quick Connect Swivel Plug	03-012-PMS
	RPB RZ Quick Connect Swivel Plug	03-052-PMS-RZ
	RPB Safety Quick Connect Swivel Plug (CE Only)	03-022-PMS
	Schrader Swivel Plug	03-042-PMS
8	Inlet Collar	03-536
9	Belt Loop and Nut	03-538
	Replacement 2" Belt	07-765
	Replacement FR Nomex® 2" Belt with Acetyl Buckles	07-765-FR



Protecting you for life's best moments.

# C40™ CLIMATE CONTROL

## LIMITED WARRANTY

RPB® warrants that its Products will be free from defects in materials and workmanship for one (1) year, subject to the terms of this limited warranty. The Products are sold only for commercial use, and no consumer warranties apply to the Products. This limited warranty is for the benefit of the original Product purchaser, and cannot be transferred or assigned. This is the sole and exclusive warranty provided by RPB®, and ALL CONDITIONS AND IMPLIED WARRANTIES (INCLUDING ANY WARRANTY OF MERCHANTABILITY OR FITNESS FOR A PARTICULAR PURPOSE) ARE EXCLUDED AND DISCLAIMED FROM WARRANTY COVERAGE. RPB's® limited warranty coverage does not apply to damage resulting from accident, improper use or misuse of the Products, wear and tear resulting from the normal use of the Products, or the failure to properly maintain the Products.

RPB's® limited warranty coverage runs from the original date of purchase of the Products, and applies only to warranted defects which first manifest themselves and are reported to RPB® within the warranty period. RPB® retains the right to determine to its reasonable satisfaction whether any claimed defect is covered by this limited warranty.

If a warranted defect occurs, RPB® will repair or replace the defective Product (or a component of the Product), in its sole discretion. This "repair or replacement" remedy is the sole and exclusive remedy under this limited warranty, and under no circumstances shall RPB's® liability under this limited warranty exceed the original purchase price for the Products (or the applicable component). RPB® has no responsibility for incidental or consequential damages, including loss of use, maintenance and other costs, and ALL INCIDENTAL AND CONSEQUENTIAL DAMAGES ARE EXCLUDED AND DISCLAIMED from this limited warranty. Contact RPB® to obtain warranty service. Proof of purchase must be provided to obtain warranty service. All costs of returning the Products to RPB® for warranty service must be paid by the purchaser.

RPB® reserves the right to improve its Products through changes in design or materials without being obligated to purchasers of previously manufactured Products.

## LIABILITY

RPB® Safety cannot accept any liability of whatsoever nature arising directly or indirectly from the use or misuse of RPB® Safety products, including purposes that the products are not designed for. RPB® Safety is not liable for damage, loss or expense resulting from the failure to give advice or information or the giving of incorrect advice or information, whether or not due to RPB® Safety's negligence or that of its employees, agents or subcontractors.

## NOTES



Protecting you for life's best moments.

# C40™ CLIMATE CONTROL

## NOTES

Notes section with horizontal dotted lines for writing.

## NOTES

# OTHER PRODUCTS

ISO9001  
CERTIFIED COMPANY

## RPB® NOVA 3® RESPIRATOR

The RPB® NOVA 3® combines breakthrough protection technology with advanced comfort and functionality, surpassing even the most rigorous industry standards and the demands of the most quality-conscious companies. Designed to optimize safety and productivity, and to minimize worker downtime, the helmet has a host of features that maximize its lifetime value.



## AIRLINE FILTRATION

The RPB® RADEX® AIRLINE FILTER offers increased capacity, versatility and filtration. This optional equipment combines the versatility of either floor or wall mounting with increased filtration capacity, enabling customization to meet worker's needs and working environments.



## AIR QUALITY MONITORING

Do you need an intelligent gas monitor that can give you complete confidence in the air you and your employees are breathing? The RPB® GX4® Gas Monitor has the ability to detect up to 4 gases simultaneously, giving you total peace of mind.



[gvs-rpb.com](http://gvs-rpb.com) | 1-866-494-4599



Protecting you for life's best moments.®